

HYP600 Microcomputer Programmable Protection Relay

Summary

HYP600 series microcomputer programmable protection relay is suitable for 110kV or below circuit as an protector, controller and monitor for the line, fuse group, motor, power transformer, three-phase asynchronism motor and parallel fuse group.



Product feature

1. Multi-interface: 8CT, 4PT, 3AI, 16/32DI, 11/16DO;
2. Multi-communication interface: 1RS485, 1CAN, 1RS232 adjustment, two ethernet and one set fiber;
3. Flexible connection: suitable for series PT, supply AC power wave and angle to check the pole;
4. Programmable: supply programme resource to make graphics, simple operating;
5. High reliability design: enough electric isolation, professional EMC design, self-checking to ensure high reliability;
6. Accident analyse and record: it can record 8 times accident wave and latest 100 items SOE event;
7. High precision measurement: the precision of voltage, current, power is 0.2 class, the precision of power and quantity is 0.5 class;
8. Accurate time-checking, communication time-checking, TRTG-B yard time-checking;
9. Plate: large LCD screen display user-defined connection, operating interface, it can O/C operating in local.

HYP-600 classified

HYP600 series relay:

| | |
|---|--|
| HYP600F feeder protection relay | HYP600R main transformer protection relay |
| HYP600T stational protection relay | HYP600P power transformer protection relay |
| HYP600M motor protection relay | HYP600N main transformer non-energy protection relay |
| HYP600C capacitor protection relay | HYP600X special type |
| HYP600B incoming/busbar coupler auto-reclosure protection relay | |

Outline dimension

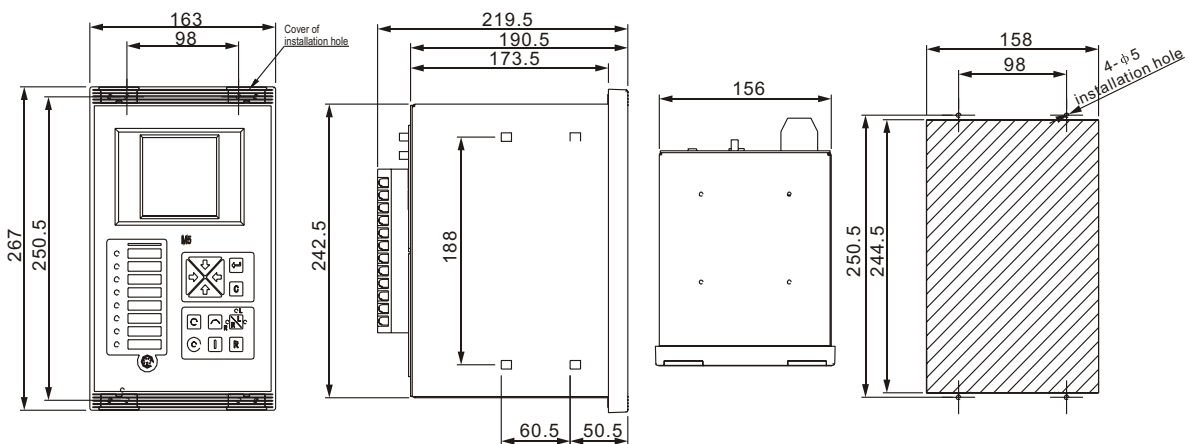

Protection function

| IEEE code | Function | 600F | 600T | 600C | 600M | 600B |
|--------------------|---|------|------|------|------|------|
| 50,67,27, 59,47 | Instantaneous quick breaking current protection | √ | | | √ | |
| 50,67,27, 59,47 | DMT quick breaking current protection | √ | √ | √ | | √ |
| 50,67,27, 59,47 | DMT over-current protection | √ | √ | √ | | √ |
| 51 | IDMT over-current(low-voltage closedown can be selected) | √ | √ | √ | √ | |
| 79 | Three-phase reclosing (checking no voltage and homochronous) | √ | | | | |
| 051A | Over-load alarm | √ | √ | | √ | |
| 51T | Over-load trip | √ | √ | | √ | |
| | Later speed-on | √ | | | | √ |
| 50N2T | Zero-sequence current protection-first | √ | | | √ | |
| 50N2T | Zero-sequence current protection-secondary | √ | | | √ | |
| 50N3T | IDMT zero-sequence current protection | √ | | | √ | |
| 59 | Over-energy protection | | √ | √ | √ | |
| 27 | Low-voltage protection | √ | √ | √ | √ | |
| 50T | Non-quantity protection | | √ | | √ | |
| | Abnormity alarm of control circuit | √ | √ | √ | √ | |
| 62BF | Failure alarm of circuit breaker | √ | √ | √ | √ | |
| 81U | Low-cycle reduce load(no voltage, no current, slipping closedown) | √ | | | | |
| 60 | Alam for PT breaking | √ | √ | √ | √ | |
| 59G | Umbalance voltage protection | | | √ | | |
| 50 | Umbalance current protection | | | √ | | |
| | Sectional ready for throw-in | | | | | √ |
| | Busbar ready for throw-in | | | | | √ |
| | Charging protection | | | | | √ |
| 50G | Direct zero-sequence over-current | | √ | | | |
| 51G | Clearance zero-sequence over-current | | √ | | | |
| | Automatic throw-in | | | √ | √ | |
| 46T1 | Backward sequence over-current definite time-first | | | | √ | |
| 46T2 | Backward sequence over-current definite time-secondary | | | | √ | |
| 46T3 | Backward sequence over-current inverse time | | | | √ | |
| 51br | Blocked protecion | | | | √ | |
| 66 | Protection for over start time | | | | √ | |
| 49 | Over-thermal protection | | | | √ | |
| 27 | Lost-voltage restart | | | | √ | |
| 59N | Zero-sequence over-voltage | | √ | | | |
| 59 | Alarm for over-voltage | | | √ | | |
| 32 | Adverse power protection | √ | | | | |
| 27T | Lost voltage trip | | | √ | √ | |
| | O/C remote of circuit breaker | √ | √ | √ | √ | √ |